

RIGID CORE LUXURY VINYL

Inspired by the beauty and majesty of Mt. Rainier, this collection draws on the variety of high alpine landscapes. From the sleek neutrals to clean modern graining, these wood visuals offer a collection of options with soft cool browns to natural blondes. This 5.0 mm waterproof rigid core vinyl plank offers a sound absorbing backing to help create a quieter environment for comfort and livability.



BENEFITS

- Dimensionally stable rigid core construction
- Premium IXPE pad attached reduces sound transfer
- Scratch, scuff and stain resistant
- Waterproof core technology protects against spills
- Polyurethane finish provides extra scratch resistance
- Longer and wider planks offer a modern design
- No transitions required for rooms up to 50' x 50' or 2,500 sf

Design, Quality, Value



tasflooring.com



Distributed by T&A Supply Company
For more info on this and other quality
flooring products visit tasflooring.com

TAS
FLOORING

SPIRE



WATERPROOF RIGID CORE
LUXURY VINYL

SPECIFICATIONS

Construction: Waterproof Rigid Core

Dimensions: 9" Wide x 60" Long, 228 mm x 1524 mm

Overall Thickness: 5.0 mm (includes 1 mm pad)

Wear Layer: 20 mil

Finish Coat: Polyurethane

Texture: Embossed

Edge Profile: Micro Bevel

Installation: Angle/Angle

Packaging: 22.433 sf/ctn - 60 ctn/plt - 1345.98 sf/plt

Warranty: 30 Yr Residential, 10 Yr Light Commercial,
10 Yr Multi-Family



SCS certified



SPIRE



AGRCU0201 | Stone



AGRCU0202 | Ozet



AGRCU0203 | Cruiser



AGRCU0204 | Crescent

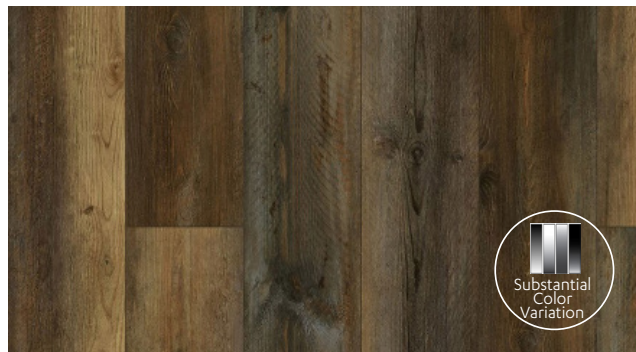

AGRCU0205 | Whiskey

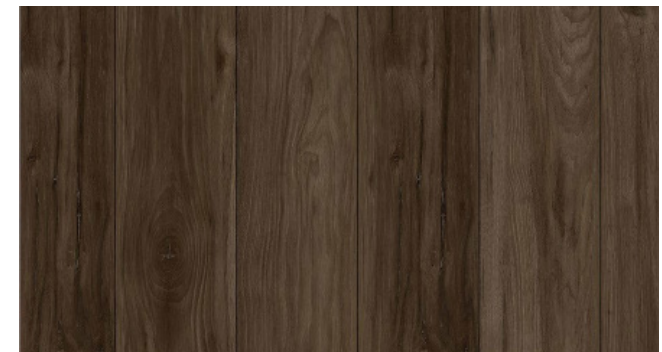

AGRCU0206 | Coho

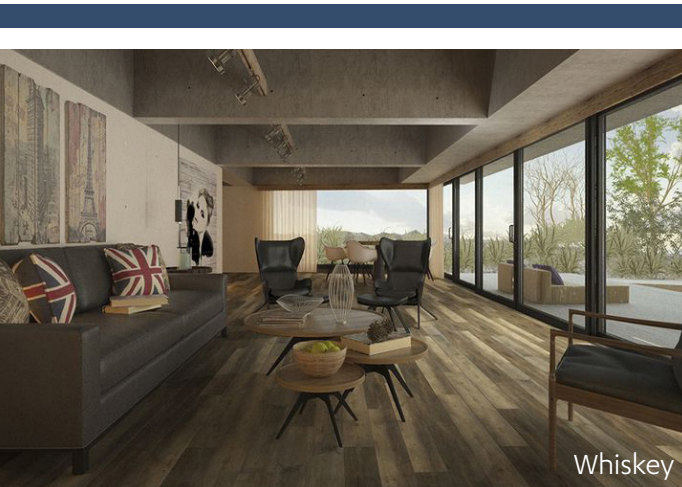

Whiskey

Installation Fast Facts:

- Radiant Heat: Approved (Hydro Systems ONLY)
- Acclimate product to normal room conditions
- Relative Humidity: 35%-55%
- Recommended Room Temp: 60° F -85° F after install
- Expansion Space: 1/4" gap
- No transitions required in rooms under 2,500 sf

Read Complete Instructions Before Installing